

BEECHCRAFT  
 BARON SERIALS TC-1 THRU TC-1607, TE-1 THRU TE-937, TE-939 THRU TE-942  
 ILLUSTRATED PARTS CATALOG

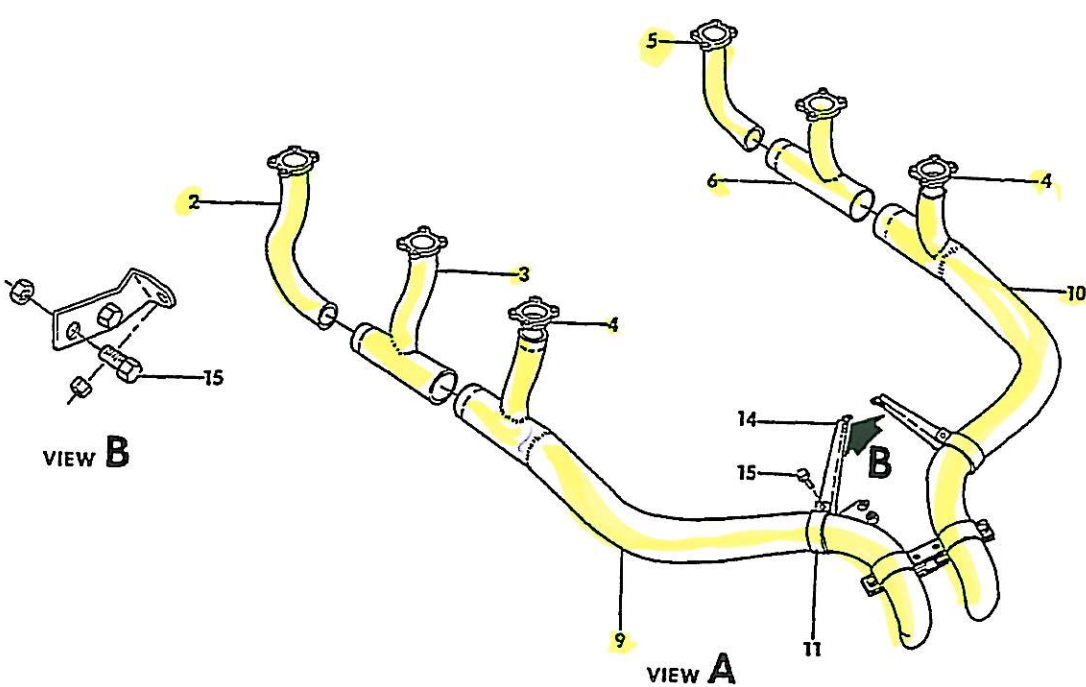
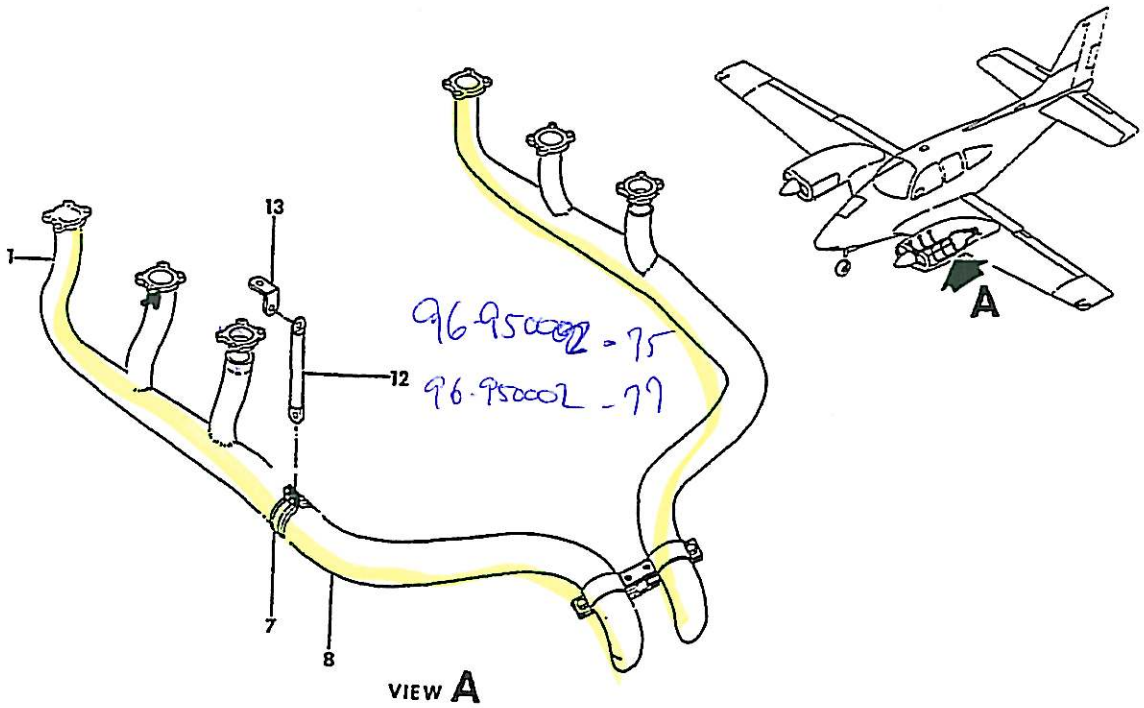

B55-245-8

B E E C H C R A F T  
S A R O N 5 5  
I L L U S T R A T E D P A R T S C A T A L O G

SUB-SECT UNIT & ITEM NO.	PART NO.	DESCRIPTION							UNITS PER ASSY	USABLE ON CODE
		1	2	3	4	5	6	7		
10-01	96-950000-47	EXHAUST SYSTEM INSTL/LH/	.	.	.	.	.	NP	1	
	96-950000-48	EXHAUST SYSTEM INSTL/RH/	.	.	.	.	.	NP	1	
	96-950000-65	EXHAUST SYSTEM INSTL/LH/	.	.	.	.	.	NP	2	
	96-950000-66	EXHAUST SYSTEM INSTL/RH/	.	.	.	.	.	NP	2	
	R 96-950002-75	EXHAUST SYSTEM, LH/SEE 78-13-01 FOR SPARES/	.	.	.	.	.	NP	3 <i>NO</i>	
	96-950002-77	EXHAUST SYSTEM, RH/SEE 78-13-01 FOR SPARES/	.	.	.	.	.	NP	3 <i>NO</i>	
- 1	96-950000-9	• STACK ASSY/LH/	.	.	.	.	.	1	1	
	96-950000-10	• STACK ASSY/RH/	.	.	.	.	.	1	1	
	96-950000-51	• STACK ASSY/LH/	.	.	.	.	.	1	2	
	96-950000-52	• STACK ASSY/RH/	.	.	.	.	.	1	2	
- 2	96-950002-9	• STACK ASSY/CYLINDER NO.6/	.	.	.	.	.	1	3	
- 3	96-950002-7	• STACK ASSY/CYLINDER NO.4/	.	.	.	.	.	1	3	
- 4	96-950002-47	• STACK ASSY/CYLINDERS NO.1 AND 2/	.	.	.	.	.	1	3 <i>x2</i>	
- 5	96-950002-33	• STACK ASSY/CYLINDER NO.5/	.	.	.	.	.	1	3	
- 6	96-950002-31	• STACK ASSY/CYLINDER NO.3/	.	.	.	.	.	1	3	
- 7	35-950004-17	• CLAMP	.	.	.	.	.	1	4	
		/ATTACHING PARTS/								
	AN4-4A	• BOLT.	.	.	.	.	.	4		
	AN960-416	• WASHER.	.	.	.	.	.	4		
	AN363-428	• NUT	.	.	.	.	.	4		
- 8	96-950000-43	• COLLECTOR ASSY/LH ENGINE OUTBD/	.	.	.	.	.	1	1	
	96-950000-61	• COLLECTOR ASSY/LH ENGINE OUTBD/	.	.	.	.	.	1	2	
	96-950000-44	• COLLECTOR ASSY/RH ENGINE INBD/	.	.	.	.	.	1	1	
	96-950000-62	• COLLECTOR ASSY/RH ENGINE INBD/	.	.	.	.	.	1	2	
	96-950000-45	• COLLECTOR ASSY/LH ENGINE INBD/	.	.	.	.	.	1	1	
	96-950000-63	• COLLECTOR ASSY/LH ENGINE INBD/	.	.	.	.	.	1	2	
	96-950000-46	• COLLECTOR ASSY/RH ENGINE OUTBD/	.	.	.	.	.	1	1	
	96-950000-64	• COLLECTOR ASSY/RH ENGINE OUTBD/	.	.	.	.	.	1	2	
- 9	96-950002-55	• COLLECTOR ASSY/LH ENGINE OUTBD/	.	.	.	.	.	1	3	
	96-950002-57	• COLLECTOR ASSY/RH ENGINE INBD/	.	.	.	.	.	1	3	
- 10	96-950002-59	• COLLECTOR ASSY/LH ENGINE INBD/	.	.	.	.	.	1	3	
		/WITHOUT MIXTURE CONTROL/								
	96-950002-61	• COLLECTOR ASSY/RH ENGINE OUTBD/	.	.	.	.	.	1	3	
		/WITHOUT MIXTURE CONTROL/								
- 11	96-950002-69	• CLAMP	.	.	.	.	.	1	3	
		/ATTACHING PARTS/								
	AN6C-15	• BOLT.	.	.	.	.	.	1		
	AN310-6	• NUT	.	.	.	.	.	1		
	MS24665-300	• PIN	.	.	.	.	.	1		
	AN960C616	• WASHER.	.	.	.	.	.	1		
- 12	96-950000-27	• SUPPORT, EXHAUST CLAMP	.	.	.	.	.	1	4	
		/ATTACHING PARTS/								
	AN3-4A	• BOLT.	.	.	.	.	.	1		
	AN960-10	• WASHER.	.	.	.	.	.	1		
	AN365-1032	• NUT	.	.	.	.	.	1		
- 13	96-950000-29	• BRACKET	.	.	.	.	.	1	4	
- 14	96-950002-73	• CHANNEL	.	.	.	.	.	1	3	
		/ATTACHING PARTS/								
- 15	AN4-5	• BOLT.	.	.	.	.	.	2		
	AN960-416	• WASHER.	.	.	.	.	.	2		
	MS20365-428C	• NUT	.	.	.	.	.	2		