

Figure 33. Main Landing Gear (D-4866 thru D-7132)

MODEL 35 PARTS CATALOG



| FIG. & INDEX NO. | PART NO. | DESCRIPTION | UNITS PER ASSY | USABLE ON CODE |
|------------------|----------------|--|----------------|----------------|
| | | 1 2 3 4 5 6 7 | | |
| 33 | 35-815001 | GEAR INSTL,MAIN LANDING LH. | NP | 1 |
| | 35-815196-1 | GEAR INSTL,MAIN LANDING LH. | NP | 2 |
| | 35-815196-21 | GEAR INSTL,MAIN LANDING LH. | NP | 3 |
| | 35-815001-1 | GEAR INSTL,MAIN LANDING RH. | NP | 1 |
| | 35-815196-2 | GEAR INSTL,MAIN LANDING RH. | NP | 2 |
| | 35-815196-22 | GEAR INSTL,MAIN LANDING RH. | NP | 3 |
| | 35-815001-608 | • GEAR ASSY,MAIN LANDING LH. /SPARE ASSY,SEE ADDENDUM/ | 1 | 1 |
| | 35-815001-10 | • GEAR ASSY,MAIN LANDING LH. | NP | 1 |
| | 35-815196-601 | • GEAR ASSY,MAIN LANDING LH. /SPARE ASSY WITH TIRE,TUBE,WHEEL & BRAKE/ | 1 | 4 |
| | □35-815196-612 | • GEAR ASSY,MAIN LANDING LH. /SPARE ASSY,LESS TIRE,TUBE,WHEEL & BRAKE/ | 1 | 4 |
| | NO NUMBER | • GEAR ASSY,MAIN LANDING LH. | NP | 4 |
| | 35-815001-609 | • GEAR ASSY,MAIN LANDING RH. /SPARE ASSY,SEE ADDENDUM/ | 1 | 1 |
| | 35-815001-11 | • GEAR ASSY,MAIN LANDING RH. | NP | I |
| | 35-815196-602 | • GEAR ASSY,MAIN LANDING RH. /SPARE ASSY,WITH TIRE,TUBE,WHEEL & BRAKE/ | 1 | 4 |
| | □35-815196-613 | • GEAR ASSY,MAIN LANDING RH. /SPARE ASSY,LESS TIRE,TUBE,WHEEL & BRAKE/ | 1 | 4 |
| | NO NUMBER | • GEAR ASSY,MAIN LANDING RH. /ATTACHING PARTS/ | NP | 4 |
| - 1 | □AN178-31 | • BOLT,FWD /SUPERSEDES NAS58-31/. | 1 | 1 |
| | □NAS148A52 | • BOLT,FWD. | 1 | 4 |
| | □NAS58-30 | • BOLT,AFT. | 1 | 1 |
| | □NAS148A50 | • BOLT,AFT. | 1 | 4 |
| - 2 | □35-815182 | • BUSHING,MAIN LANDING GEAR | 2 | |
| - 3 | □100951X063XD | • WASHER. | 2 | |
| | □AN310-8 | • NUT | 2 | |
| | AN380-3-3 | • PIN,COTTER | 2 | |
| | | * | | |
| | □35-810150-4 | • . . ABSORBER ASSY,MAIN LANDING GEAR SHOCK LH. /SPARE ASSY,SEE ADDENDUM/ | 1 | 1 |
| | 35-810150 | • . . ABSORBER ASSY,MAIN LANDING GEAR SHOCK LH. | NP | 1 |
| | 35-815192-1 | • . . ABSORBER ASSY,MAIN LANDING GEAR SHOCK LH. | NP | 2 |
| | 35-815192-43 | • . . ABSORBER ASSY,MAIN LANDING GEAR SHOCK LH. | NP | 3 |
| | □35-810150-5 | • . . ABSORBER ASSY,MAIN LANDING GEAR SHOCK RH. /SPARE ASSY,SEE ADDENDUM/ | 1 | 1 |
| | 35-810150-1 | • . . ABSORBER ASSY,MAIN LANDING GEAR SHOCK RH. | NP | 1 |
| | 35-815192-2 | • . . ABSORBER ASSY,MAIN LANDING GEAR SHOCK RH. | NP | 2 |
| | 35-815192-44 | • . . ABSORBER ASSY,MAIN LANDING GEAR SHOCK RH. | NP | 3 |
| - 4 | □45-815202 | • . . . ABSORBER ASSY,LOWER SHOCK LH. | 1 | 1 |
| | 35-815192-5 | • . . . ABSORBER ASSY,LOWER SHOCK LH. | 1 | 2 |
| | 35-815192-33 | • . . . ABSORBER ASSY,LOWER SHOCK LH. | 1 | 3 |
| | □45-815202-1 | • . . . ABSORBER ASSY,LOWER SHOCK RH. | 1 | 1 |
| | 35-815192-6 | • . . . ABSORBER ASSY,LOWER SHOCK RH. | 1 | 2 |
| | 35-815192-34 | • . . . ABSORBER ASSY,LOWER SHOCK RH. | 1 | 3 |
| | □45-815217-4 | • . . . CONTROL ASSY,MAIN GEAR REBOUND. | 1 | 1 |
| | NO NUMBER | • . . . CONTROL ASSY,MAIN GEAR REBOUND. | NP | 4 |
| | □45-815218 | • . . . TUBE ASSY,MAIN GEAR REBOUND | 1 | 1 |
| | 35-815192-7 | • . . . TUBE ASSY,ORIFICE REBOUND | 1 | 2 |
| | 35-815192-41 | • . . . TUBE ASSY,ORIFICE REBOUND | 1 | 3 |
| - 5 | 45-815218-2 | • TUBE,MAIN GEAR REBOUND. | 1 | 1 |
| | 35-815192-17 | • TUBE,ORIFICE REBOUND. | 1 | 4 |
| - 6 | 45-815219 | • HEAD,MAIN GEAR REBOUND. | 1 | 1 |
| | 35-815192-19 | • HEAD,ORIFICE REBOUND. | 1 | 2 |
| | 35-815192-37 | • HEAD,ORIFICE REBOUND. | 1 | 3 |
| - 7 | 45-815220 | • COLLAR,MAIN GEAR REBOUND. | 1 | 1 |
| | 35-815192-21 | • CAP,ORIFICE REBOUND | 1 | 4 |
| - 8 | 45-815221 | • VALVE,MAIN GEAR REBOUND CONTROL | 1 | 1 |
| - 9 | □NAS50-112 | • RING. | 1 | 1 |

| FIG. & INDEX NO. | PART NO. | 1 | 2 | 3-4 | 5 | 6 | 7 | DESCRIPTION | UNITS PER ASSY | USABLE ON CODE |
|------------------------|---------------|---|---|-----|---|---|---|---|----------------------|----------------------|
| 33 | 35-380020 | . | . | . | . | . | . | RING,MAIN GEAR STRUT PISTON | 1 | 4 |
| | 45-815222 | . | . | . | . | . | . | PIN ASSY,MAIN GEAR REBOUND CONTROL. | 1 | 1 |
| - 10 | 45-815222-2 | . | . | . | . | . | . | PIN,MAIN GEAR REBOUND | 1 | 1 |
| - 11 | 45-815223-2 | . | . | . | . | . | . | HEAD,MAIN GEAR REBOUND CONTROL PIN. | 1 | 1 |
| - 12 | □35-815066 | . | . | . | . | . | . | SLEEVE,MAIN GEAR REBOUND CONTROL PIN. | 1 | 1 |
| | □45-815203-2 | . | . | . | . | . | . | ABSORBER ASSY,MAIN GEAR UPPER SHOCK LH. | 1 | 1 |
| | 35-815192-3 | . | . | . | . | . | . | ABSORBER ASSY,MAIN GEAR UPPER SHOCK LH. | 1 | 4 |
| | □45-815203-3 | . | . | . | . | . | . | ABSORBER ASSY,MAIN GEAR UPPER SHOCK RH. | 1 | 1 |
| | 35-815192-4 | . | . | . | . | . | . | ABSORBER ASSY,MAIN GEAR UPPER SHOCK RH. | 1 | 4 |
| | 45-815213-4 | . | . | . | . | . | . | BARREL ASSY,MAIN GEAR ABSORBER. | 1 | 1 |
| | 35-815192-9 | . | . | . | . | . | . | BARREL ASSY,MAIN GEAR ABSORBER. | 1 | 4 |
| - 13 | 45-815213-2 | . | . | . | . | . | . | TUBE,SHOCK ABSORBER | 1 | 1 |
| | 35-815192-23 | . | . | . | . | . | . | TUBE,SHOCK ABSORBER | 1 | 4 |
| - 14 | 45-815214 | . | . | . | . | . | . | FITTING,MAIN GEAR BARREL END. | 1 | 1 |
| | □35-815192-13 | . | . | . | . | . | . | HEAD,MAIN GEAR BARREL END | 1 | 4 |
| | □45-815215 | . | . | . | . | . | . | BEARING ASSY,MAIN GEAR BARREL UPPER | 1 | |
| - 15 | 45-815215-2 | . | . | . | . | . | . | TUBE. | 1 | |
| - 16 | 45-815215-4 | . | . | . | . | . | . | BUSHING | 1 | |
| - 17 | 45-815230 | . | . | . | . | . | . | FITTING,MAIN GEAR BEARING LOWER | 1 | |
| - 18 | □45-815231 | . | . | . | . | . | . | BEARING,MAIN GEAR LOWER | 1 | |
| | 45-815040 | . | . | . | . | . | . | TRUSS ASSY,MAIN GEAR SHOCK ABSORBER LH. | 1 | 1 |
| | 95-810010-7 | . | . | . | . | . | . | TRUSS ASSY,MAIN GEAR SHOCK ABSORBER LH. | 1 | 4 |
| | 45-815040-1 | . | . | . | . | . | . | TRUSS ASSY,MAIN GEAR SHOCK ABSORBER RH. | 1 | 1 |
| | 95-810010-8 | . | . | . | . | . | . | TRUSS ASSY,MAIN GEAR SHOCK ABSORBER RH. | 1 | 4 |
| - 19 | 45-815040-16 | . | . | . | . | . | . | WELD ASSY,SHOCK ABSORBER LH | 1 | 1 |
| | 45-815040-17 | . | . | . | . | . | . | WELD ASSY,SHOCK ABSORBER RH | 1 | 1 |
| - 20 | □MS15002-1 | . | . | . | . | . | . | FITTING,LUBRICATION | 2 | |
| | 35-815086-4 | . | . | . | . | . | . | BRACKET,UPPER ABSORBER BARREL LH. | 1 | 4 |
| | 35-815086-5 | . | . | . | . | . | . | BRACKET,UPPER ABSORBER BARREL RH. | 1 | 4 |
| - 21 | □45-815224 | . | . | . | . | . | . | PLUG,MAIN LANDING GEAR BARREL END | 1 | 1 |
| - 22 | □NAS50-200 | . | . | . | . | . | . | RING,SNAP | 1 | 1 |
| | □NAS50-262 | . | . | . | . | . | . | RING,SNAP | 1 | 4 |
| - 23 | □AN6230-2 | . | . | . | . | . | . | GASKET | 1 | 1 |
| | □AN6230-7 | . | . | . | . | . | . | GASKET | 1 | 4 |
| - 24 | □45-815225 | . | . | . | . | . | . | LOCK,MAIN LANDING GEAR BARREL END | 1 | 1 |
| | □35-815088-10 | . | . | . | . | . | . | BODY ASSY,MAIN GEAR VALVE & FILLER PLUG | 1 | 1 |
| | □35-815088-18 | . | . | . | . | . | . | BODY ASSY,MAIN GEAR VALVE & FILLER PLUG | 1 | 4 |
| - 25 | 35-815088-4 | . | . | . | . | . | . | BODY,VALVE & FILLER PLUG. | 1 | |
| - 26 | 35-815088-6 | . | . | . | . | . | . | TUBE,VALVE & FILLER PLUG. | 1 | 1 |
| | 35-815088-16 | . | . | . | . | . | . | TUBE,VALVE & FILLER PLUG. | 1 | 4 |
| - 27 | □302D | . | . | . | . | . | . | CORE /SUPERSEDES AN809-1/ | 1 | |
| - 28 | AN813-1A | . | . | . | . | . | . | CAP | 1 | |
| - 29 | □AN6290-5 | . | . | . | . | . | . | GASKET /SUPERSEDES AN902-5/ | 1 | |
| - 30 | □AN6227-31 | . | . | . | . | . | . | RING,O. | 1 | |
| - 31 | MS28776-20R | . | . | . | . | . | . | SCRAPER | 1 | 1 |
| | □MS28776-20 | . | . | . | . | . | . | SCRAPER | 1 | 4 |
| - 32 | □AN6227-6 | . | . | . | . | . | . | RING,O. | 1 | 1 |
| - 33 | □111200-6 | . | . | . | . | . | . | RING,SNAP | 1 | |
| - 34 | □45-815232 | . | . | . | . | . | . | SCRAPER,COMPOSITION WIPER | 1 | |
| - 35 | □35-815081 | . | . | . | . | . | . | WASHER,MAIN GEAR EXTENSION STOP PIN | 1 | 5 |
| - 36 | □AN365-524 | . | . | . | . | . | . | NUT | 1 | 5 |
| | □45-815011-6 | . | . | . | . | . | . | KNEE ASSY,MAIN GEAR TORQUE UPPER. | 1 | |
| | | . | . | . | . | . | . | /ATTACHING PARTS/ | | |
| - 37 | □45-815014 | . | . | . | . | . | . | PIN,MAIN GEAR TORQUE KNEE ATTACHING | 1 | 1 |
| | □45-815237 | . | . | . | . | . | . | PIN,MAIN GEAR TORQUE KNEE ATTACHING | 1 | 4 |
| - 38 | □AN392-27 | . | . | . | . | . | . | PIN,CLEVIS. | 1 | |
| | □AN380-2-1 | . | . | . | . | . | . | PIN,COTTER. | 1 | |
| - 39 | □45-815011-4 | . | . | . | . | . | . | KNEE,TORQUE | 1 | |
| - 40 | □45-815013 | . | . | . | . | . | . | BUSHING,MAIN GEAR TORQUE. | 2 | |
| - 41 | □1729 | . | . | . | . | . | . | FITTING,ALEMITE | 3 | |
| | □45-815015-6 | . | . | . | . | . | . | KNEE ASSY,MAIN GEAR TORQUE LOWER. | 1 | 1 |

MODEL 35 PARTS CATALOG



| FIG. & INDEX NO. | PART NO. | DESCRIPTION | UNITS PER ASSY | USABLE ON CODE |
|------------------|-----------------|--|----------------|----------------|
| 33 | 335-815194 | . . . KNEE ASSY,MAIN GEAR TORQUE LOWER. /ATTACHING PARTS/ | 1 | 4 |
| - 42 | 345-815014 | . . . PIN,MAIN GEAR TORQUE ATTACHING. | 1 | 1 |
| | 345-815237 | . . . PIN,MAIN GEAR TORQUE ATTACHING. | 1 | 4 |
| - 43 | 3AN392-23 | . . . PIN,CLEVIS. | 1 | |
| | 3AN380-2-1 | . . . PIN,COTTER. | 1 | |
| | | -----* | | |
| - 44 | 345-815015-4 | KNEE,TORQUE | 1 | 1 |
| | 335-815194-1 | KNEE,TORQUE | 1 | 4 |
| - 45 | 345-815013 | BUSHING,MAIN GEAR TORQUE KNEE | 2 | |
| - 46 | 3MS15002-1 | FITTING | 2 | |
| - 47 | 3AN5-13 | BOLT. | 1 | |
| - 48 | 3105739S-YK0431 | BUSHING | 1 | |
| | 3AN960-516 | WASHER. | 1 | |
| | 3AN310-5 | NUT | 1 | |
| | 3AN380-2-3 | PIN,COTTER. | 1 | |
| - 49 | 335-815043 | . . . TUBE ASSY,HYDRAULIC BRAKE TRUSS LH. | 1 | |
| | 335-815044 | . . . TUBE ASSY,HYDRAULIC BRAKE TRUSS RH. | 1 | |
| - 50 | 3AN815-4D | . . . UNION | 1 | |
| - 51 | 335-815004 | . . . CLAMP ASSY,LANDING GEAR DOOR ATTACHING LH | 1 | |
| | 335-815004-1 | . . . CLAMP ASSY,LANDING GEAR DOOR ATTACHING RH /ATTACHING PARTS/ | 1 | |
| - 52 | 3AN4-10A | . . . BOLT. | 1 | |
| | 3AN960-416 | . . . WASHER. | 1 | |
| | 3AN365-428 | . . . NUT | 1 | |
| | | -----* | | |
| - 53 | 335-815023 | . . . BUSHING,MAIN LANDING GEAR WHEEL SPACER. | 1 | 6 |
| | 335-815023 | . . . BUSHING,MAIN LANDING GEAR WHEEL SPACER. /USE WITH TUBELESS TIRE/ | 2 | 7 |
| - 54 | 335-810072 | . . . SPACER,LANDING GEAR INNER WHEEL | 1 | 8 |
| | 335-810072 | . . . SPACER,LANDING GEAR INNER WHEEL | 2 | 3 |
| - 55 | 311731 | . . . BRAKE ASSY,LANDING GEAR WHEEL | 1 | 1 |
| | | /SEE FIG. 34/ | | |
| | 311731M | . . . BRAKE ASSY,LANDING GEAR WHEEL | 1 | 9 |
| | | /SEE FIG. 34/ | | |
| | 39532167 | . . . BRAKE ASSY,GEAR DRIVE /SEE FIG. 34/ /USE WITH TUBELESS TIRE/ | 1 | 10 |
| | 39532475 | . . . BRAKE ASSY,TWO SPOT GEAR DRIVE. /SEE FIG. 34A/ | 1 | 11 |
| | 39532412 | . . . BRAKE ASSY,TWO SPOT GEAR DRIVE. /ALTERNATE FOR 9532475/ | 1 | 11 |
| | 39532679 | . . . BRAKE ASSY. /ATTACHING PARTS/ | 1 | 15 |
| - 56 | 3AN4-10A | . . . BOLT. | 6 | |
| | 3AN960-416 | . . . WASHER. | 6 | |
| | 3AN365-428 | . . . NUT | 6 | |
| | | -----* | | |
| - 57 | 39530949 | . . . WHEEL ASSY,MAIN LANDING GEAR. /SEE FIG. 34/ | 1 | 1 |
| | 3530869M | . . . WHEEL ASSY,MAIN LANDING GEAR. /SEE FIG. 34/ /ALTERNATE FOR 9530949/ | 1 | 6 |
| | 39532135 | . . . WHEEL ASSY,GEAR DRIVE /SEE FIG. 34/ /USE WITH TUBELESS TIRE/ /ATTACHING PARTS/ | 1 | 18 |
| - 58 | 3AN7502-24 | . . . NUT | 1 | |
| | 3AN380-4-8 | . . . PIN,COTTER. | 1 | |
| | | -----* | | |
| - 59 | 3650X8 | . . . TIRE,/SEE FIG. 34/. | 1 | 8 |
| | 3650X8 | . . . TIRE,4 PLY TUBELESS /SEE FIG. 34/ /USED WITH P/N 9532135 & 9532167/ | 1 | 16 |
| | 3650X8 | . . . TIRE,6 PLY TUBELESS /USED WITH 9532679/ | 1 | 17 |
| | 3600X6 | . . . TIRE,6 PLY TUBELESS | 1 | 19 |
| - 60 | 3650X8 | . . . TUBE,/SEE FIG. 34/. | 1 | 6 |
| - 61 | 3MS28741-4-0153 | . . . HOSE /SUPERSEDES 3AN6271-4-15 3/8/ | 1 | 1 |
| | 3MS28741-4-0153 | . . . HOSE ASSY | 1 | 4 |
| - 62 | 3AN815-4D | . . . UNION | 1 | 8 |
| | 3AN919-6D | . . . UNION | 1 | 13 |
| | 3AN902-4 | . . . GASKET. | 1 | 1 |
| | 3AN6290-4 | . . . GASKET. | 1 | 14 |
| | 3AN6290-6 | . . . GASKET. | 1 | 12 |

| FIG. & INDEX NO. | PART NO. | DESCRIPTION | UNITS PER ASSY | | | | | | | USABLE ON CODE | |
|------------------|----------------|---|----------------|---|---|---|---|---|---|----------------|----|
| | | | 1 | 2 | 3 | 4 | 5 | 6 | 7 | | |
| 33 - 53 | AN832-4D | • • UNION | | | | | | | | 1 | |
| | AN960-716 | • • WASHER | | | | | | | | 1 | |
| | AN924-4 | • • NUT | | | | | | | | 1 | |
| - 54 | 35-815038 | • • CLAMP ASSY, HYDRAULIC BRAKE LINE /ATTACHING PARTS/ | | | | | | | | 1 | |
| - 55 | AN4-7A | • • BOLT | | | | | | | | 2 | |
| | AN960-416 | • • WASHER | | | | | | | | 2 | |
| | AN365-428 | • • NUT | | | | | | | | 2 | |
| | 35-815001-8 | • • SHIM, CLAMP LINE | | | | | | | | 1 | |
| - 66 | 35-810158 | • • PLACARD, SHOCK STRUT FILLING INSTRUCTION LH. | | | | | | | | 1 | 1 |
| | 35-810160 | • • PLATE, SHOCK STRUT FILLING INSTRUCTIONS LH . | | | | | | | | 1 | 2 |
| | 35-810162 | • • PLATE, SHOCK STRUT FILLING INSTRUCTIONS LH . | | | | | | | | 1 | 3 |
| | 35-810159 | • • PLACARD, SHOCK STRUT FILLING INSTRUCTION RH. | | | | | | | | 1 | 1 |
| | 35-810161 | • • PLATE, SHOCK STRUT FILLING INSTRUCTIONS RH . | | | | | | | | 1 | 2 |
| | 35-810163 | • • PLATE, SHOCK STRUT FILLING INSTRUCTIONS RH . | | | | | | | | 1 | 3 |
| - 67 | 35-810150-2 | • • FELT | | | | | | | | 1 | |
| - 68 | MS28741-4-0153 | • • HOSE ASSY | | | | | | | | 1 | 4 |
| | 95-3218 | • • ADAPTER, BLEEDER | | | | | | | | 1 | 14 |
| | 95-5039 | • • VALVE, HYDRAULIC BLEEDER | | | | | | | | 1 | 14 |
| | AN6290-4 | • • GASKET /SUPERSEDES AN6204-2/ | | | | | | | | 1 | 14 |
| | AN502-10-4 | • • SCREW | | | | | | | | 1 | 14 |

CODE EFFECTIVITY

CODE EFFECTIVITY

| | | | |
|----|---|----|---|
| 1 | D-4866 THRU D-5790 | 2 | D-5791 THRU D-6585 |
| 3 | D-6586 THRU D-7132 | 4 | D-5791 THRU D-7132, D-7208, D-7213 AND D-7214 |
| 5 | D-4866 THRU D-5790, D-5952, D-5954, D-5959, D-5961 THRU D-6161 | 6 | D-4866 THRU D-5985 |
| 7 | D-5986 THRU D-6585 | 8 | D-4866 THRU D-5985 |
| 9 | D-5791 THRU D-6492 | 10 | D-5986 THRU D-6492 |
| 11 | D-6493 THRU D-7159 | 12 | D-5986 THRU D-7214 EXCEPT D-7209 THRU D-7212 |
| 13 | D-5796 THRU D-6161 | 14 | D-5796 THRU D-5985 |
| 15 | D-7160 THRU D-7214 EXCEPT D-7209 THRU D-7212 | 16 | D-5986 THRU D-7159 |
| 17 | D-7160 THRU D-7208 | 18 | D-5986 THRU D-7214 EXCEPT D-7209 THRU D-7212 |
| 19 | D-7209 THRU D-7212, D-7215 AND AFTER | | |

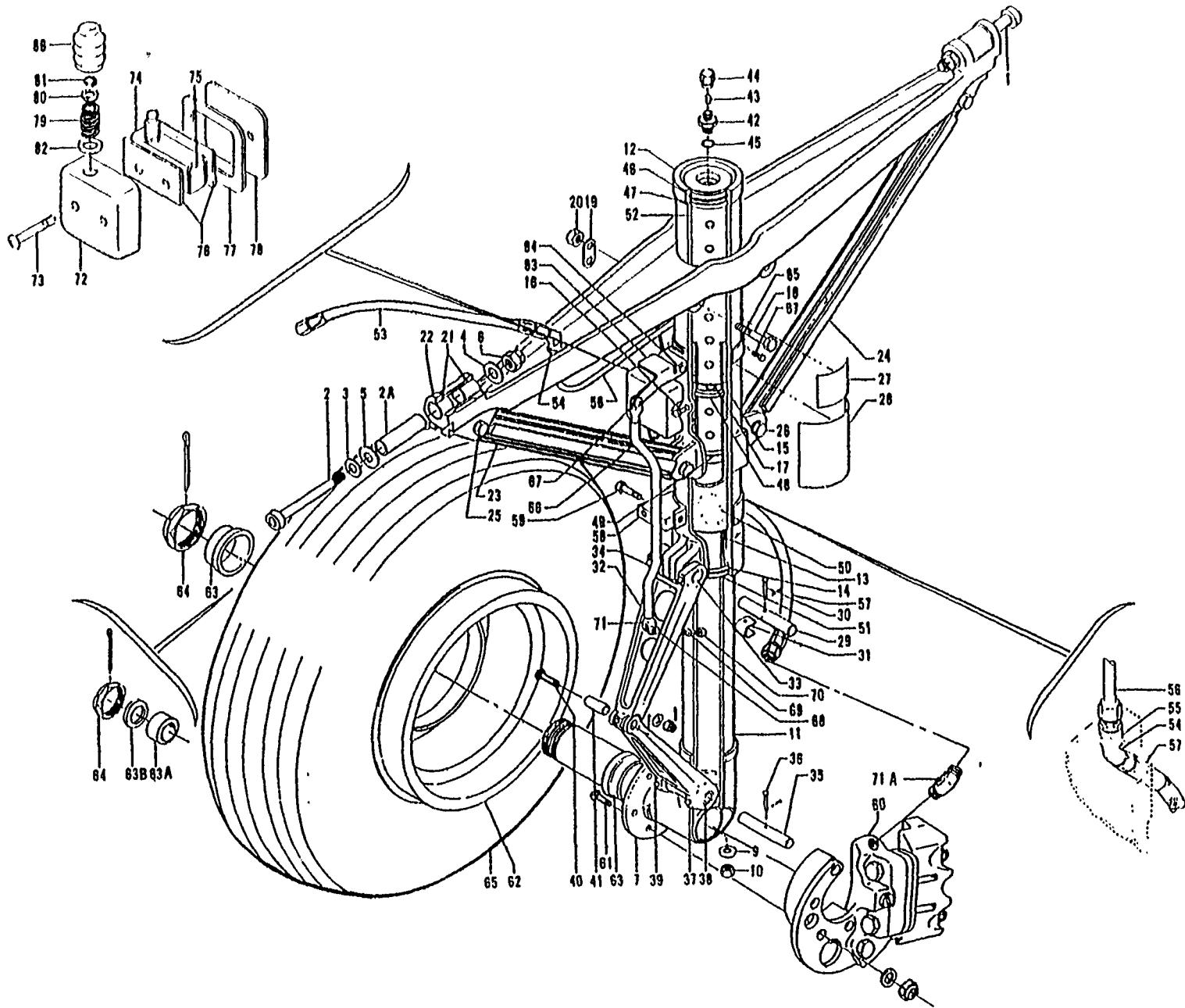

Figure 33A. Main Landing Gear (D-7133 And After)

| FIG. & INDEX NO. | PART NO. | DESCRIPTION | | | | | | UNITS PER ASSY | USABLE ON CODE |
|------------------------|-----------------|---|---|---|---|---|---|----------------------|----------------------|
| | | 1 | 2 | 3 | 4 | 5 | 6 | | |
| 33A- | 35-815254-655 | GEAR ASSY,MAIN LANDING LH | | | | | | 1 | 7 |
| | | /LESS TIRE,WHEEL AND BRAKE/ | | | | | | | |
| | 35-815254-656 | GEAR ASSY,MAIN LANDING RH | | | | | | 1 | 7 |
| | | /LESS TIRE,WHEEL AND BRAKE/ | | | | | | | |
| | 35-810026-603 | GEAR ASSY,MAIN LANDING LH /COMPLETE/. | | | | | | 1 | 4 |
| | | /STANDARD/ /MULTI-DISC BRAKE/ | | | | | | | |
| | 35-810026-604 | GEAR ASSY,MAIN LANDING RH /COMPLETE/. | | | | | | 1 | 4 |
| | | /STANDARD/ /MULTI-DISC BRAKE/ | | | | | | | |
| | 35-815254-615 | GEAR ASSY,MAIN LANDING LH /COMPLETE/. | | | | | | 1 | 4 |
| | | /OPTIONAL/ /SINGLE DISC BRAKE/ | | | | | | | |
| | 35-815254-616 | GEAR ASSY,MAIN LANDING RH /COMPLETE/. | | | | | | 1 | 4 |
| | | /OPTIONAL/ /SINGLE DISC BRAKE/ | | | | | | | |
| | | /ATTACHING PARTS/ | | | | | | | |
| - 1 | NAS148A67 | BOLT. | | | | | | 1 | |
| - 2 | NAS148A69/M/ | BOLT. | | | | | | 1 | |
| - 2A | 35-815250 | BUSHING | | | | | | 2 | |
| - 3 | NAS143-8C | WASHER /SUPERSEDES MS20002CB/ | | | | | | 2 | |
| - 4 | AN960-816 | WASHER. | | | | | | 2 | |
| - 5 | 100951S016XF | WASHER /USED BETWEEN GEAR & SPAR FITTING IF | | | | | | 2 | |
| | | GAP IS 0.016 TO 0.031/ | | | | | | | |
| | 100951S032XF | WASHER /USED BETWEEN GEAR & SPAR FITTING IF | | | | | | 2 | |
| | | GAP IS 0.032 TO 0.047/ | | | | | | | |
| - 6 | AN310-8 | NUT | | | | | | 2 | |
| | AN380-3-3 | PIN,COTTER /SUPERSEDES MS24665-283/ | | | | | | 2 | |
| | | /ATTACHING PARTS/ | | | | | | | |
| | 35-815192-33 | . SHOCK ASSY,LOWER LH | | | | | | 1 | 1 |
| - 7 | 35-815260-1 | . SHOCK ASSY,LOWER LH /SUPERSEDES 35-815192-45/ | | | | | | 1 | 8 |
| | 35-815192-34 | . SHOCK ASSY,LOWER RH | | | | | | 1 | 1 |
| | 35-815260-2 | . SHOCK ASSY,LOWER RH /SUPERSEDES 35-815192-46/ | | | | | | 1 | 8 |
| - 8 | | . . . DELETED | | | | | | | |
| - 9 | 35-815081 | . . WASHER. | | | | | | 1 | 3 |
| - 10 | MS20365-524 | . . NUT /SUPERSEDES AN365-524/. | | | | | | 1 | 3 |
| - 11 | 35-815192-27 | . . PISTON ASSY | | | | | | 1 | 3 |
| - 12 | 35-815246-5 | . CYLINDER,LH | | | | | | 1 | 3 |
| | 35-815246-7 | . CYLINDER,RH | | | | | | 1 | 3 |
| - 13 | 35-815246-9 | . BEARING,LOWER | | | | | | 1 | 3 |
| - 14 | RRN237C | . RING,RETAINING. | | | | | | 1 | 3 |
| - 15 | 35-815246-11 | . BEARING,UPPER | | | | | | 1 | 3 |
| - 16 | SALP-T6-6 | . HOOKBOLT. | | | | | | 2 | 3 |
| | 6LC-C6 | . COLLAR. | | | | | | 2 | 3 |
| - 17 | MS28775-138 | . O RING. | | | | | | 1 | 3 |
| - 18 | NAS334CPA30 | . BOLT. | | | | | | 2 | 3 |
| - 19 | 35-815256 | . CONNECTOR,BRACE TO CLAMP. | | | | | | 2 | 3 |
| - 20 | MS20365-428 | . NUT | | | | | | 2 | 3 |
| - 21 | 10DU12 | . BUSHING | | | | | | 4 | 3 |
| - 22 | 35-815251-3 | . BRACE | | | | | | 1 | 3 |
| - 23 | 35-815252-1 | . COLUMN,FWD. | | | | | | 1 | 3 |
| - 24 | 35-815252-3 | . COLUMN,AFT. | | | | | | 1 | 3 |
| | | /ATTACHING PARTS/ | | | | | | | |
| - 25 | NAS464P7LA16/M/ | . BOLT. | | | | | | 2 | |
| - 26 | 35-815247-15 | . BOET. | | | | | | 2 | |
| | AN960D716 | . WASHER. | | | | | | 4 | |
| | MS20364-720 | . NUT | | | | | | 4 | |
| | | /ATTACHING PARTS/ | | | | | | | |
| - 27 | 112406 | . PLACARD | | | | | | 1 | 3 |
| - 28 | 96-810166 | . PLATE,LH INSTRUCTION. | | | | | | 1 | 1 |
| | 96-810165 | . PLATE,RH INSTRUCTION. | | | | | | 1 | 1 |
| | 35-810171 | . PLATE,LH INSTRUCTION. | | | | | | 1 | 2 |
| | 35-810170 | . PLATE,RH INSTRUCTION. | | | | | | 1 | 2 |
| | 96-810020 | . PLATE,LH INSTRUCTION. | | | | | | 1 | 4 |
| | 96-810021 | . PLATE,RH INSTRUCTION. | | | | | | 1 | 4 |
| | 45-815011-10 | . KNEE ASSY,UPPER | | | | | | 1 | 3 |
| | | /ATTACHING PARTS/ | | | | | | | |
| - 29 | 45-815237 | . PIN | | | | | | 1 | |
| - 30 | MS20392-1-21 | . PIN | | | | | | 1 | |
| - 31 | 35-815253 | . STOP. | | | | | | 1 | |

| FIG. & INDEX NO. | PART NO. | 1 | 2 | 3 | 4 | 5 | 6 | 7 | DESCRIPTION | UNITS PER ASSY | USABLE ON CODE |
|------------------|----------------|---|---|---|---|---|---|---|--|----------------|----------------|
| 33A- 32 | 45-815011-8 | . | . | . | . | . | . | . | KNEE,UPPER. | 1 | 3 |
| - 33 | 45-815013 | . | . | . | . | . | . | . | BUSHING | 2 | 3 |
| - 34 | 1729 | . | . | . | . | . | . | . | FITTING,ZERK. | 3 | 3 |
| | 35-815194-3 | . | . | . | . | . | . | . | KNEE ASSY,LOWER TORQUE /SUPERSEDES 35-815194/ /ATTACHING PARTS/ | 1 | 3 |
| - 35 | 45-815237 | . | . | . | . | . | . | . | PIN | 1 | |
| - 36 | AN392-27 | . | . | . | . | . | . | . | PIN /SUPERSEDES MS20392-1-27/ | 1 | |
| | MS24665-130 | . | . | . | . | . | . | . | PIN,COTTER /SUPERSEDES AN380-2-1/ | 2 | |
| - 37 | 35-815194-5 | . | . | . | . | . | . | . | KNEE,LOWER /SUPERSEDES 35-815194-1/ | 1 | 3 |
| - 38 | 45-815013 | . | . | . | . | . | . | . | BUSHING | 2 | 3 |
| - 39 | MS15002-1 | . | . | . | . | . | . | . | FITTING,ZERK. | 2 | 3 |
| - 40 | AN5-13/M/ | . | . | . | . | . | . | . | BOLT. | 1 | 3 |
| - 41 | 1057395-YK0431 | . | . | . | . | . | . | . | BUSHING | 1 | 3 |
| | AN960-516 | . | . | . | . | . | . | . | WASHER. | 1 | 3 |
| | AN310-5 | . | . | . | . | . | . | . | NUT | 1 | 3 |
| | AN380-2-3 | . | . | . | . | . | . | . | PIN,COTTER. | 1 | 3 |
| - 42 | 118642-7 | . | . | . | . | . | . | . | BODY,AIR VALVE. | 1 | 3 |
| - 43 | 302D | . | . | . | . | . | . | . | CORE,AIR VALVE /SUPERSEDES AN809-1/ | 1 | 3 |
| - 44 | AN813-1B | . | . | . | . | . | . | . | CAP /SUPERSEDES MS20813-1/. | 1 | 3 |
| - 45 | MS28778-5 | . | . | . | . | . | . | . | GASKET. | 1 | 3 |
| - 46 | RRN237C | . | . | . | . | . | . | . | RING,RETAINING. | 1 | 3 |
| - 47 | AN6230B5 | . | . | . | . | . | . | . | GASKET. | 1 | 3 |
| - 48 | AN6227B31 | . | . | . | . | . | . | . | PACKING | 1 | 3 |
| - 49 | 35-380020-1 | . | . | . | . | . | . | . | RING,PISTON | 1 | 3 |
| - 50 | 35-815247-9 | . | . | . | . | . | . | . | FELT. | 1 | 3 |
| - 51 | 504271 | . | . | . | . | . | . | . | SEAL,SCRAPER. | 1 | 3 |
| - 52 | 35-815249-1 | . | . | . | . | . | . | . | BRAZE ASSY,ORIFICE. | 1 | 3 |
| - 53 | MS28741-4-0125 | . | . | . | . | . | . | . | HOSE ASSY,UPPER | 1 | 3 |
| - 54 | AN837-4D | . | . | . | . | . | . | . | ELBOW | 2 | 9 |
| - 55 | AN960D716 | . | . | . | . | . | . | . | WASHER. | 3 | 9 |
| | AN924-4D | . | . | . | . | . | . | . | NUT | 2 | 9 |
| | AN818-4D | . | . | . | . | . | . | . | NUT | 2 | 10 |
| | AN819-4 | . | . | . | . | . | . | . | SLEEVE. | 2 | 10 |
| - 56 | 95-810002-3 | . | . | . | . | . | . | . | TUBE ASSY,LH. | 1 | 9 |
| | 35-815254-25 | . | . | . | . | . | . | . | TUBE ASSY,LH UPPER. | 1 | 10 |
| | 95-810002-4 | . | . | . | . | . | . | . | TUBE ASSY,RH UPPER. | 1 | 9 |
| | 35-815254-26 | . | . | . | . | . | . | . | TUBE ASSY,RH UPPER. | 1 | 10 |
| - 57 | MS28741-4-0140 | . | . | . | . | . | . | . | HOSE ASSY,LOWER | 1 | 9 |
| | MS28741-4-0180 | . | . | . | . | . | . | . | HOSE ASSY,LOWER | 1 | 10 |
| - 58 | 35-815004 | . | . | . | . | . | . | . | CLAMP ASSY,LH | 1 | 9 |
| | 35-815264-1 | . | . | . | . | . | . | . | CLAMP ASSY,LH | 1 | 10 |
| | 35-815004-1 | . | . | . | . | . | . | . | CLAMP ASSY,RH | 1 | 9 |
| | 35-815264-2 | . | . | . | . | . | . | . | CLAMP ASSY,RH | 1 | 10 |
| - 59 | AN4-10A/M/ | . | . | . | . | . | . | . | BOLT. | 1 | 9 |
| | AN4-14/M/ | . | . | . | . | . | . | . | BOLT. | 1 | 10 |
| | AN960-416 | . | . | . | . | . | . | . | WASHER. | 1 | 3 |
| | MS20365-428 | . | . | . | . | . | . | . | NUT | 1 | 3 |
| | 35-815196-17 | . | . | . | . | . | . | . | WHEEL & BRAKE ASSY,BALANCED | 1 | 1 |
| | 95-810002-15 | . | . | . | . | . | . | . | WHEEL & BRAKE ASSY,LH | 1 | 2 |
| | 95-810002-16 | . | . | . | . | . | . | . | WHEEL & BRAKE ASSY,RH | 1 | 2 |
| | 95-810002-23 | . | . | . | . | . | . | . | WHEEL & BRAKE ASSY,LH /OPTIONAL/. | 1 | 4 |
| | 95-810002-24 | . | . | . | . | . | . | . | WHEEL & BRAKE ASSY,RH /OPTIONAL/. | 1 | 4 |
| | 35-810026-7 | . | . | . | . | . | . | . | WHEEL & BRAKE ASSY,LH & RH /STANDARD/ | 1 | 5 |
| | 35-810026-23 | . | . | . | . | . | . | . | WHEEL & BRAKE ASSY,LH & RH /STANDARD/ | 1 | 6 |
| - 60 | 95-32412 | . | . | . | . | . | . | . | BRAKE ASSY. | 1 | 1 |
| | | . | . | . | . | . | . | . | /SUPERSEDES 95-32475/ /SEE FIG. 33/ | | |
| | 95-300001-5 | . | . | . | . | . | . | . | BRAKE ASSY,LH /SEE FIG. 34B/. | 1 | 2 |
| | 95-300001-6 | . | . | . | . | . | . | . | BRAKE ASSY,RH /SEE FIG. 34B/. | 1 | 2 |
| | 35-8002-25 | . | . | . | . | . | . | . | BRAKE ASSY,LH & RH /SEE FIG. 34D/ | 1 | 4 |
| | | . | . | . | . | . | . | . | /SUPERSEDES 35-8002-5/ /ATTACHING PARTS/ | | |
| - 61 | AN4-10A/M/ | . | . | . | . | . | . | . | BOLT. | 6 | 1 |
| | AN960-416 | . | . | . | . | . | . | . | WASHER. | 6 | 1 |
| | MS20365-428 | . | . | . | . | . | . | . | NUT | 6 | 1 |
| | NAS145-24 | . | . | . | . | . | . | . | BOLT. | 4 | 2 |
| | MS20002C5 | . | . | . | . | . | . | . | WASHER. | 4 | 2 |
| | AN960-516 | . | . | . | . | . | . | . | WASHER. | 4 | 2 |
| | MS20365-524 | . | . | . | . | . | . | . | NUT | 4 | 2 |



MODEL 35 PARTS CATALOG

| FIG. & INDEX NO. | PART NO. | 1 | 2 | 3 | 4 | 5 | 6 | 7 | DESCRIPTION | UNITS PER ASSY | USABLE ON CODE |
|------------------|----------------|---|---|--------------------------------------|---|---|---|---|-------------|----------------|----------------|
| 33A- 62 | 95-32135 | . | . | WHEEL ASSY /SEE FIG. 33/ | . | . | . | . | NP | 1 | |
| | 35-8002-3 | . | . | WHEEL ASSY /SEE FIG. 34e/ /STANDARD/ | . | . | . | . | 1 | 4 | |
| | 95-300001-73 | . | . | WHEEL ASSY /SEE FIG. 34C/ /OPTIONAL/ | . | . | . | . | 1 | 4 | |
| | 95-810002-9 | . | . | WHEEL & TIRE ASSY | . | . | . | . | 1 | 2 | |
| - 63 | 35-810072 | . | . | BUSHING | . | . | . | . | 2 | 1 | |
| | 35-815023 | . | . | BUSHING | . | . | . | . | 1 | 2 | |
| - 63A | 35-815254-9 | . | . | BUSHING | . | . | . | . | 1 | 2 | |
| - 63B | 100951X100WL | . | . | WASHER | . | . | . | . | 1 | 2 | |
| - 64 | AN7502-24 | . | . | NUT | . | . | . | . | 1 | 3 | |
| | AN380-4-8 | . | . | PIN,COTTER | . | . | . | . | 1 | 1 | |
| - 65 | 6 50X8 6P TL | . | . | TIRE,6 PLY SIDEWALL INFLATED | . | . | . | . | 1 | 1 | |
| | 7 00X6 6P TT | . | . | TIRE,6 PLY /TUBE TYPE/ | . | . | . | . | 1 | 4 | |
| | 7 00X6 | . | . | TUBE,TIRE | . | . | . | . | 1 | 4 | |
| - | 7 00X6 6P TL | . | . | TIRE,6 PLY SIDEWALL INFLATED | . | . | . | . | 1 | 2 | |
| | 96-300001-67 | . | . | WHEEL ASSY /SEE FIG. 34C/ | . | . | . | . | 1 | 2 | |
| - 66 | 35-361145 | . | . | LINK ASSY,LANDING GEAR SAFETY SWITCH | . | . | . | . | 1 | 3 | |
| | | . | . | /ATTACHING PARTS/ | . | . | . | . | | | |
| - 67 | AN393-13 | . | . | PIN | . | . | . | . | 2 | | |
| | AN960D10 | . | . | WASHER | . | . | . | . | 2 | | |
| | MS24665-130 | . | . | PIN,COTTER /SUPERSEDES AN380-2-1/ | . | . | . | . | 2 | | |
| - 68 | AN42-4 | . | . | EYEBOLT | . | . | . | . | 1 | 3 | |
| - 69 | AN960-10L | . | . | WASHER | . | . | . | . | 2 | 3 | |
| - 70 | AN310-3 | . | . | NUT | . | . | . | . | 1 | 3 | |
| - 71 | AN161-16RS | . | . | FORK | . | . | . | . | 1 | 3 | |
| | AN919-6U | . | . | REDUCER | . | . | . | . | 1 | 1 | |
| | MS28778-6 | . | . | PACKING | . | . | . | . | 1 | 1 | |
| - 71A | AN823-4 | . | . | ELBOW /SUPERSEDES MS20823-4/ | . | . | . | . | 1 | 2 | |
| | 35-361131-671 | . | . | SWITCH ASSY,LANDING GEAR SAFETY | . | . | . | . | 1 | 3 | |
| | | . | . | /SUPERSEDES 35-361131/ | . | . | . | . | | | |
| - 72 | 35-361135-1 | . | . | BOX,LANDING GEAR SAFETY SWITCH | . | . | . | . | 1 | 3 | |
| - 73 | AN526-632-22 | . | . | SCREW | . | . | . | . | 2 | 3 | |
| | AN960A6 | . | . | WASHER /SUPERSEDES AN960D6/ | . | . | . | . | 2 | 3 | |
| | MS20365-632 | . | . | NUT /SUPERSEDES AN365-632/ | . | . | . | . | 2 | 3 | |
| - 74 | MC2711 | . | . | ACTUATOR | . | . | . | . | 1 | 3 | |
| - 75 | BZ3YT | . | . | SWITCH | . | . | . | . | 1 | 3 | |
| - 76 | 45-364238 | . | . | INSULATOR | . | . | . | . | 2 | 3 | |
| - 77 | 35-361136 | . | . | GASKET | . | . | . | . | 1 | 3 | |
| - 78 | 35-361134 | . | . | COVER | . | . | . | . | 1 | 3 | |
| - 79 | 35-361150 | . | . | SPRING | . | . | . | . | 1 | 3 | |
| - 80 | 100951DD032YF | . | . | WASHER | . | . | . | . | 1 | 3 | |
| - 81 | NAS51-31 | . | . | RING,SNAP | . | . | . | . | 1 | 3 | |
| - 82 | AN960A816L | . | . | WASHER | . | . | . | . | 1 | 3 | |
| - 83 | 35-361132-1 | . | . | ARM,SAFETY SWITCH | . | . | . | . | 1 | 3 | |
| - 84 | AN393-29 | . | . | PIN | . | . | . | . | 1 | 3 | |
| | AN960D10 | . | . | WASHER | . | . | . | . | 1 | 3 | |
| | MS24665-130 | . | . | PIN,COTTER | . | . | . | . | 1 | 3 | |
| - 85 | 35-361133 | . | . | BRACKET ASSY | . | . | . | . | 1 | 3 | |
| | 106242-7-03600 | . | . | TUBING,INSULATING | . | . | . | . | 1 | 3 | |
| - 86 | 35-361148-1 | . | . | BOOT | . | . | . | . | 1 | 3 | |
| - 87 | AN3-11A/M/ | . | . | BOLT | . | . | . | . | 1 | 3 | |
| | AN960D10 | . | . | WASHER | . | . | . | . | 2 | 3 | |
| | MS20365-1032 | . | . | NUT | . | . | . | . | 1 | 3 | |

CODE EFFECTIVITY

CODE EFFECTIVITY

- | | | | |
|---|--|----|---|
| 1 | D-7133 THRU D-7208, D-7213 AND D-7214 | 2 | D-7209 THRU D-7212, D-7215 THRU D-8497 |
| 3 | D-7133 AND AFTER | 4 | D-8498 AND AFTER |
| 5 | D-8498 THRU D-8591 | 6 | D-8592 AND AFTER |
| 7 | D-7133 THRU D-8497 | 8 | D-7209 THRU D-7212, D-7215 AND AFTER |
| 9 | D-7133 THRU D-8171 | 10 | D-8172 AND AFTER |