

# 416-50 Fuel Cap Parts

BE35: J35 – early N35 - S/N D-5331 – D-6745

Non-Indexing Cap

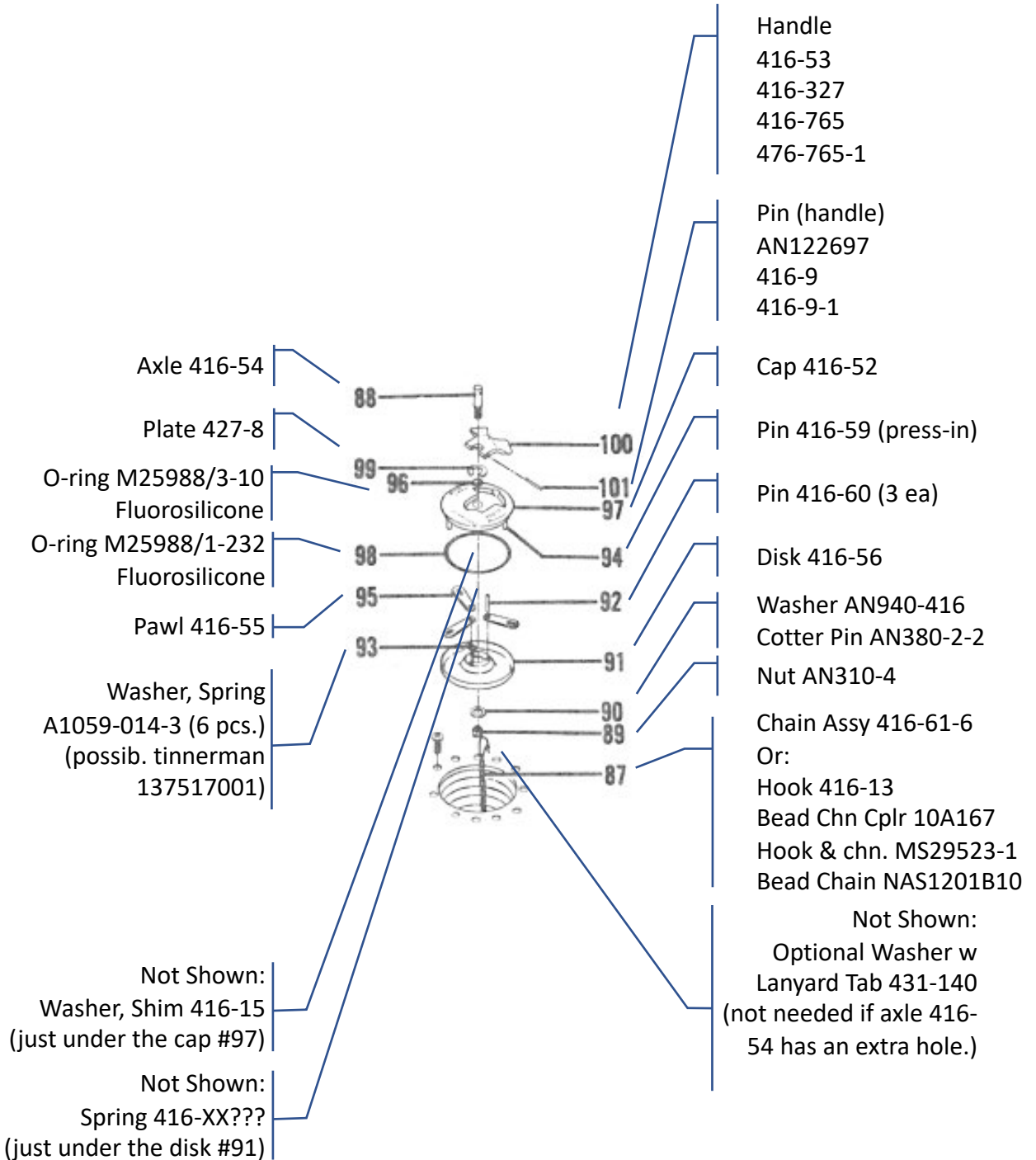

		M35 Parts Book Locator	Beech P/N	Alt P/N	Per cap	Alt source
O-Ring (perimeter)	fluorosilicone		M25988/1-232			
O-Ring (shaft)	fluorosilicone		M25988/3-10			
Handle	Wear Item	55-100	416-53		1	
				alt 416-327		muduncan.aero POR
				416-765		muduncan.aero POR
				416-765-1		myduncan.aero \$32
Plate	Wear Item	55-99	427-8		1	
Axle	Corrosion	55-88	416-54		1	
Pin (handle)	Damage	55-101	AN122697		1	
				alt 416-9		muduncan.aero POR
				416-9-1		
Pawl	worn?	55-95	416-55		3	
Pin (pawl)		55-92	416-60		3	
Spring (plate)	missing 3	55-93	A1059-014-3		6	Arrel A/C \$? and Aeroval \$2.80
			NSN 5310-00-950-3009			Tinnerman 137517001
chain		55-87	416-16-6		1	
			hook 416-13			
cap (top)		55-97	416-52		1	
disk (bottom)		55-91	416-56		1	
washer			416-15		1	preferredairparts

Contact: Alan Preferred Airparts

New: From Debonair Parts Book:

Hook (for chain)	Debonair parts 287A-14	416-13			
Bead Chain Coupler	Debonair parts 287A-13	10A167			
Hook, Chain	Debonair parts 287A	MS29523-1			myduncan.aero \$4.31
Chain, Beaded		NAS1201B10			
Washer, Lanyard Tab	Debonair parts 287A-7	431-140			



## Preferred Airparts, LLC

Div. of JILCO Industries, Inc.  
 PO Box 12  
 Kidron, OH 44636  
 Ph: 800-433-0814, or 330-698-0280  
 Fax: 330-698-3164

## Quotation

**Quote #:** Q1026654  
**Date:** 5/9/2019  
**Time:** 3:11:28 PM  
**# of Items:** 10  
**Page:** 1  
**Prepared By:** Alan Streit Ext 208

**To:**  
**Bill Jacobs**  
**150 South Elm Street**  
**Denver, CO 80246**

**Ship To:**  
**Bill Jacobs**  
**150 South Elm Street**  
**Denver, CO 80246**

**Quote Date:** 5/9/2019  
**Code:** BJ17

**Ref #:**  
**Site:** \_  
**Terms:** C.O.D.

**Phone #:** 303-359-9954  
**Contact:**  
**Email:** bill@thejacobs.org

**Fax #:** N/A

*The following is in response to your Request For Quote*

Item	Part Number/Description	CD	Qty	Unit Price	Line Amt
1	<b>416-327 Handle</b> Delivery Terms: STOCK	NS	97	\$45.00EA	\$4,365.00
2	<b>416-765 Handle</b> Delivery Terms: STOCK	NS	40	\$20.00EA	\$800.00
3	<b>416-147-2 Washer</b> Delivery Terms: STOCK	NS	19	\$0.02EA	\$0.38
4	<b>416-229 Ring</b> Delivery Terms: STOCK	NS	4	\$100.00EA	\$400.00
5	<b>416-54 Axle</b> Delivery Terms: STOCK	NS	14	\$25.00EA	\$350.00
6	<b>416-148 Spring</b> Delivery Terms: STOCK Cone shape, 3/4" long	NS	9	\$2.50EA	\$22.50
7	<b>427-8 Plate</b> Delivery Terms: STOCK	NS	6	\$1.50EA	\$9.00
8	<b>416-53 Handle</b> Delivery Terms: STOCK	NS	2	\$20.00EA	\$40.00
9	<b>AN122697 Pin</b> Delivery Terms: STOCK	NS	41	\$2.11EA	\$86.51
10	<b>416-55 Pawl</b> Delivery Terms: STOCK	NS	15	\$20.00EA	\$300.00

Prices quoted are US\$ and do not include freight charges.  
 All parts quoted are subject to prior sale. Prices valid 30 days  
 We can ship parts promptly upon receipt of your order.  
 NS = New Surplus Price is each. Minimum order is \$20.00 US\$  
 Material Certification on NS unless otherwise noted

**Sub Total:** \$6,373.39

**Misc Charge:** \$0.00

**Freight:** \$0.00

**Total:** \$6,373.39

**Authorized Signature:** Alan Streit

Payable in USD

MODEL 35 PARTS CATALOG

FIG. & INDEX NO.	PART NO.	DESCRIPTION	UNITS PER ASSY	USABLE ON CODE
		1 2 3 4 5 6 7		
55 -	□35-921218-6	. CELL,WING FUEL RH /20 GAL./ . . . . .	1	1
	□95-380027-2	. CELL,WING FUEL RH /25 GAL./ . . . . .	1	4
<p>NOTE WHEN THE 95-380027-1 LH OR 95-380027-2 RH CELLS ARE USED TO REPLACE ORIGINAL EQUIPMENT ON D-5752,D-5757 THRU D-5795,D-5797 THRU D-5820,D-5822 THRU D-5984 AND D-5903 THRU D-5906,THE FOLLOWING PARTS ARE REQUIRED.            50-110010-106 COVER 2 EA,50-110010-108 LH DOOR 1 EA,50-110010-109 RH DOOR 1 EA,50-110010-110 LH LINER 1 EA,50-110010-111 RH LINER 1 EA.</p>				
- 77	□45-921541	. STRAINER ASSY,WING FUEL . . . . .	2	5
- 78	□1517127	. TRANSMITTER . . . . .	2	1
	□50-920071	. TRANSMITTER . . . . .	2	30
	□5640556	. TRANSMITTER,LH. . . . .	1	31
	□5641801	. TRANSMITTER,RH. . . . .	1	31
		/ATTACHING PARTS/		
	□AN502-10-6	. SCREW . . . . .	4	
- 79	□AN502-10-8	. SCREW . . . . .	1	
-----*-----				
- 80	□35-921503	. GASKET,TRANSMITTER. . . . .	1	5
- 81	□CCA3400	. VALVE,DRAIN . . . . .	1	5
		/ATTACHING PARTS/		
	□35-921532	. WASHER,FUEL CELL DRAIN. . . . .	1	
- 82	□35-921533	. CLAMP,FUEL CELL DRAIN . . . . .	1	
-----*-----				
- 83	□45-921544	. ADAPTER ASSY,FUEL FILLER CAP. . . . .	1	28
		/USED WITH 20,25 OR 39 GAL. TANKS/		
	□37826	. ADAPTER ASSY,FUEL FILLER CAP. . . . .	1	22
		/USED WITH 25 OR 39 GAL. TANKS/		
	35-921249	. ADAPTER ASSY,FUEL FILLER CAP. . . . .	1	24
		/USED WITH 25,39 OR 40 GAL. TANKS/		
	35-921249-3	. ADAPTER ASSY,FUEL FILLER CAP. . . . .	1	26
		/USED WITH 25 OR 40 GAL. TANKS/		
		/ATTACHING PARTS/		
	□AN960-416L	. WASHER. . . . .	12	
- 84	□AN74-3/M/	. BOLT. . . . .	12	
- 85	□AN509-10R9	. SCREW . . . . .	12	
-----*-----				
- 86	□35-921502	. GASKET. . . . .	1	5
	□416-85	. CAP ASSY,FUEL FILLER /REPLACES. . . . .	1	1
		416-25-20 & 416-85-20/		
	□416-85-25	. CAP ASSY,FUEL FILLER. . . . .	1	27
	FC153-100	. CAP ASSY,FUEL FILLER. . . . .	1	26
- 87	□416-61-6	. CHAIN ASSY,FUEL TANK 6-INCH . . . . .	1	28
	□416-50	. CAP ASSY,FUEL 3-INCH FILLER . . . . .	1	28
- 88	□416-54	. AXLE,FUEL TANK CAP. . . . .	1	28
- 89	□AN310-4	. NUT . . . . .	1	28
- 90	□AN940-416	. WASHER. . . . .	1	28
	AN380-2-2	. PIN,COTTER. . . . .	1	28
- 91	□416-56	. DISC,FUEL TANK CAP ANCHOR . . . . .	1	28
		/ATTACHING PARTS/		
- 92	□416-60	. PIN . . . . .	3	
-----*-----				
- 93	□A1059-014-3	. WASHER,SPRING . . . . .	6	28
- 94	□416-59	. PIN,FUEL TANK CAP DRIVE . . . . .	3	28
- 95	□416-55	. PAWL,FUEL TANK CAP. . . . .	3	28
- 96	□MS29513-10	. RING,FUEL TANK CAP O. . . . .	1	28
- 97	416-52	. BASE,FUEL TANK CAP. . . . .	1	28
- 98	□MS29513-232	. RING,FUEL TANK CAP O. . . . .	1	28
- 99	□427-8	. PLATE,FUEL TANK CAP BEARING . . . . .	1	28
-100	416-53	. HANDLE,FUEL TANK CAP. . . . .	1	28
		/ATTACHING PARTS/		
-101	□AN122697	. PIN . . . . .	1	
-----*-----				

MODEL 35 PARTS CATALOG

FIG. & INDEX NO.	PART NO.	DESCRIPTION	UNITS PER ASSY	USABLE ON CODE
55 -	□35-921241-1	. PLACARD,91/96 GRADE FUEL /WHITE/.	2	6
-102	□35-921241-3	. PLACARD,91/96 GRADE FUEL /BLACK/.	2	6
	□35-921243-1	. PLACARD,100/130 GRADE FUEL /WHITE/.	2	12
	□35-921243-3	. PLACARD,100/130 GRADE FUEL /BLACK/.	2	12
	□35-921252-1	. PLACARD,100/130 GRADE FUEL 39 GAL. /WHITE/.	2	13
	□35-921252-3	. PLACARD,100/130 GRADE FUEL 39 GAL. /BLACK/.	2	13
	□35-921252-5	. PLACARD,100/130 GRADE FUEL 40 GAL. /WHITE/.	2	36
	□35-921252-7	. PLACARD,100/130 GRADE FUEL 40 GAL. /BLACK/.	2	36
	□35-921238-1	. PLACARD,FUEL FILLER CAP 91/96 OCTANE /WHITE/.	1	6
	□35-921238-3	. PLACARD,FUEL FILLER CAP 91/96 OCTANE /BLACK/.	1	6
-103	□95-921016-1	. PLACARD,CAUTION,DO NOT INSERT /WHITE/.	2	12
	□95-921016-3	. PLACARD,CAUTION,DO NOT INSERT /BLACK/.	2	12
-104	□95-921018-1	. PLACARD,FUEL 39 GAL. /WHITE/.	2	12
	□95-921018-3	. PLACARD,FUEL 39 GAL. /BLACK/.	2	12
-105	□35-924148	. PLACARD,FUEL CELL SUMP DRAIN.	2	5
	□37810-1	. CAP ASSY,FUEL FILLER.	1	23
-106	□C37656-41	. HANDLE,FUEL TANK CAP.	1	23
-107	□37059	. PIN,HANDLE.	1	23
-108	□37117	. PLATE,FUEL TANK CAP BEARING.	1	23
-109	□MS9021-110	. O RING,FUEL TANK CAP /SUPERSEDES 37615-110/	1	23
-110	37685-2	. BASE,FUEL TANK CAP.	1	23
-111	□37617-339	. O RING,FUEL TANK CAP.	1	23
-112	□37691	. RETAINER,FUEL TANK CAP.	1	23
-113	□37693	. SPRING,FUEL TANK CAP.	1	23
-114	□38038	. LOCK,FUEL TANK CAP.	1	23
-115	38104	. COUPLING,FUEL TANK CAP CHAIN.	1	23
-116	AN381-3-8	. PIN,COTTER.	1	23

CODE EFFECTIVITY

CODE EFFECTIVITY

1	D-5331 THRU D-5725	2	D-5726 THRU D-6561
3	D-6562 AND AFTER	4	D-5726 AND AFTER
5	D-5331 AND AFTER	6	D-5331 THRU D-6561
7	D-5726 THRU D-6161	8	D-5331 THRU D-6107
9	D-6108 THRU D-6561	10	D-5331 THRU D-7828
11	D-7829 AND AFTER	12	D-6562 THRU D-6974
13	D-6975 THRU D-7309	14	D-6632,D-6874 THRU D-7067
15	D-6562 THRU D-6873, EXCEPT D-6632	16	D-6842 THRU D-7309
17	D-6562 THRU D-6654	18	D-6655 AND AFTER
19	D-5331 THRU D-6285	20	D-6286 THRU D-6841
21	D-6162 THRU D-6561	22	D-6746 THRU D-6974
23	D-6746 AND AFTER EXCEPT D-7310 THRU D-7319	24	D-6975 AND AFTER EXCEPT D-7310 THRU D-7319
25	D-6286 THRU D-7309	26	D-7310 THRU D-7319
27	D-5726 THRU D-6745	28	D-5331 THRU D-6745
29	D-5331 THRU D-7309	30	D-5726 THRU D-7079
31	D-7080 AND AFTER	32	D-6562 THRU D-7079
33	D-5331 THRU D-7067	34	D-7068 AND AFTER
35	D-6562 THRU D-7309	36	D-7310 AND AFTER
37	D-6632,D-6874 AND AFTER	38	D-5331 THRU D-6873 EXCEPT D-6632
39	D-7068 THRU D-7309	40	D-5726 THRU D-7309